

18AUSI* - AUXILIARY COMPONENTS PNEUMATIC SYSTEMS

Auxiliary components for pneumatic systems.

OUTPUT FLOW REGULATOR - BANJO

Thread x Tube diameter	C	E	G	K	Key	Code
M5x4	18,5	27	4,5	9,5	8	18AUSI-REG10K510405
1/4"x6	24	36,5	6	13	17	18AUSI-REG-10K510628

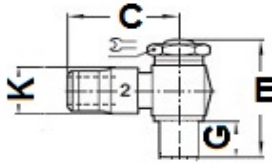

SINTERED BRONZE SILENCERS

Thread	C	D	G	Key	Code
M5	20	5	5	7	18AUSI-SIL-BSM5
1/4"	33	12	8	17	18AUSI-SIL-BS1/4
3/8"	44	17	10	22	18AUSI-SIL-BS3/8
1/2"	56	20	12	27	18AUSI-SIL-BS1/2

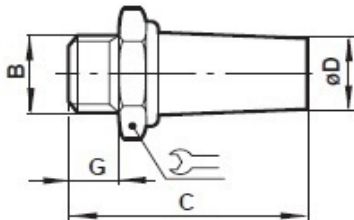

SILENCERS IN ACETAL RESIN

ABS granulated filter part

Thread	A	C	D	Code
1/8"	15,5	6	26,5	18AUSI-SIL-ES1/8
1/4"	19,5	8	35	18AUSI-SIL-ES1/4

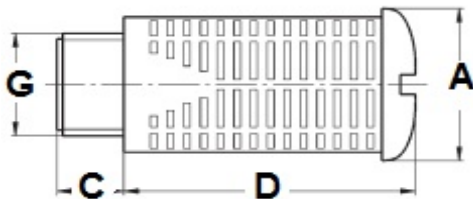

SATEMA

13856 VIGLIANO B.SE - Via Milano, 395

Tel. +39 015811102

Mail: info@satema.it

<http://www.satema.it>

18AUSI* - AUXILIARY COMPONENTS PNEUMATIC SYSTEMS

SILENCERS WITH FLOW REGULATOR

Nylon body and gasket, porous polyethylene silencer, steel adjustment screw.

Thread	G	C	D	Code
1/4"	7	29	18	18AUSI-REG-T20-1/4

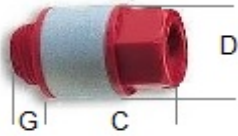

EXHAUST DISPENSERS WITH SILENCER

Brass body, sintered bronze silencer, NBR gasket

G	B	C	Ch	Code
1/4"	17,5	8	16	18AUSI-REG-URS2
1/4"				18AUSI-REG-ASN20S

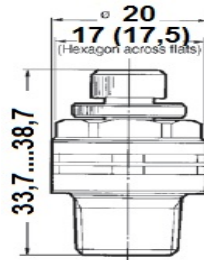
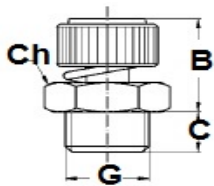

URS*

ASN*

OR. TEE SELECTOR VALVES

They allow the connection of two independent signal sources to a common driving line. Can be used for a logical 'OR' function. Can be combined to operate from three or four power sources. The valves can be installed in series.

Thread	Codi
1/4"	18AUSI-VAT-T65C2800



QUICK DISCHARGE VALVES

Valve whose outlet is immediately opened to discharge whenever the air pressure value at the inlet drops. The air coming from the system enters from P, moves the pad, excluding exhaust R and goes to outlet A.

A thread	B	L1	L2	CH	Code
1/8"	8,5	42	19,5	15	18AUSI-VSR-60501
1/2"	15	72	32	26	18AUSI-VSR-60504

REPLACEMENT MEMBRANES

	Code
1/8"	18AUSI-VSR-6050M1
1/2"	18AUSI-VSR-6050M4

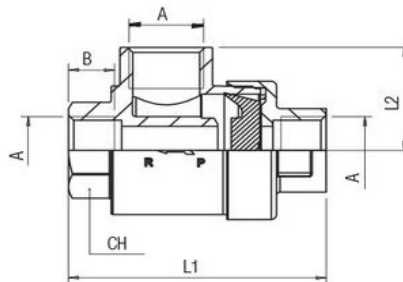

SATEMA

13856 VIGLIANO B.SE - Via Milano, 395

Tel. +39 015811102

Mail: info@satema.it

<http://www.satema.it>

18AUSI* AUXILIARY COMPONENTS PNEUMATIC SYSTEMS

Male-Female connection MINIATURE BALL VALVES

A	B	G	L	Ch	H	Code
1/4"	1/4"	19	43	14-15	21	18AUSI-SFE-VSM02

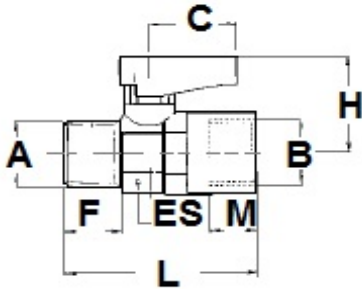

UNI-DIRECTIONAL CHECK VALVES - Brass body

A	B	L	CH	Code
3/8"	12	58	24	18AUSI-VRI-606203

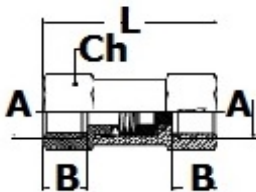

SLIDER VALVE

A	B	L	CH	Code
1/4"	30	58	17	18AUSI-VCO-606002

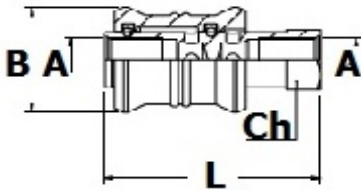

FREE DRAINAGE SAFETY VALVE

Brass pressure relief valve, Teflon seat. Adjustable calibration. PN16. Suitable for medium pressure tanks and for non-hazardous fluids discharged into the air.

G thread	A	D	H	Code
1/4	28	7,5	77	18AUSI-VSI-84T01
3/8	28	10	77	18AUSI-VSI-84T02
1/2	30	13	85	18AUSI-VSI-84T03
3/4	43	19	104	18AUSI-VSI-84T04
1"	53	24,5	118	18AUSI-VSI-84T05
1"1/4	63	31,5	136	18AUSI-VSI-84T06
1"1/2	78	38	145	18AUSI-VSI-84T07
2"	89	48	167	18AUSI-VSI-84T08

Version with metal seat code *84M*

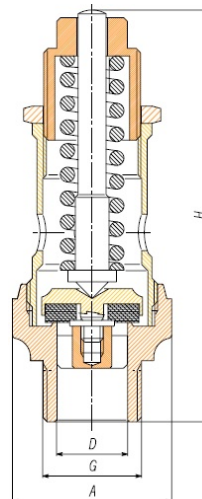

SATEMA

13856 VIGLIANO B.SE - Via Milano, 395

Tel. +39 015811102

Mail: info@satema.it

<http://www.satema.it>

18AUSI* AUXILIARY COMPONENTS PNEUMATIC SYSTEMS

BIDIRECTIONAL REGULATING VALVES

Bidirectional flow regulators. Oil flow rates regulated from 0.5 to 80 L/min.

Operating pressure 210 Bar brass body, 400 bar steel body

Max Temperature -20...+100°C

Brass version: Nickel-plated OT58 body, X 10 Cr Ni S 1809 - UNI 6900, GD AI Si 12 knob - UNI EN AB 46100

Steel version: Body 11 S Mn Pb 30 - UNI EN 10087, needle 1 C 40 - UNI 8373, knob GD AI Si 12 - UNI EN AB 46100

Nitrile compound Oring, PTFE anti-extrusion ring

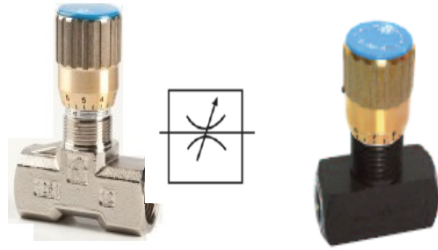

A	B	C	D	E	F / F1	G	H	L	CH
OT 1/8"	8	40	55	4	22 / 40	12	M15X1	9,5	15
OT 1/2"	16	70	82	10	33 / 70	13	M25X1,5	19	27
ACC 1/8"	8,5	38	59	64	22 / 40	13,5	M17x1		16

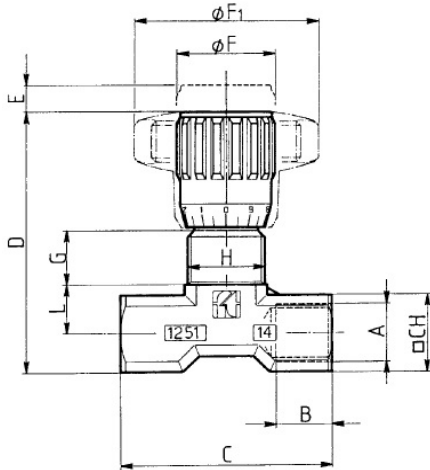

Body	Diameter	Passage mm2	Code
Steel	1/8"	0,12	18ZOLC-VAL-257/2-1/8
Brass	1/8"	7,07	18AUSI-VRE-FT123701
Brass	1/2"	50,27	18AUSI-VRE-FT125104



SATEMA

13856 VIGLIANO B.SE - Via Milano, 395

Tel. +39 015811102

Mail: info@satema.it

<http://www.satema.it>