

## 18PFRL\* EXCELON SERIES COMPRESSED AIR TREATMENT

### GENERAL FILTERS EXCELON SERIES F73G, F74G MODELS

G3/8 to G1/2

Fluid:

- Only compressed air

Inlet Pressure:

- 10 bar max

Ambient temperature:

- +2... +50°C (on request -34...50°C)



Dimensions

| Model      | Drain  | Bowl        | Code       | Diameter | A   | B   | C  | F  | G  | Flow dm <sup>3</sup> /s |
|------------|--------|-------------|------------|----------|-----|-----|----|----|----|-------------------------|
| <b>F73</b> | Manual | Transparent | F73G3GNQT3 | 3/8"     | 156 | 216 | 25 | 68 | 62 | 35                      |
| <b>F74</b> | Manual | Protected   | F74G4GNQP3 | 1/2"     | 177 | 246 | 25 | 80 | 74 | 38                      |

B# minimum clearance for removal cup

|                               |                  |                      |                         |
|-------------------------------|------------------|----------------------|-------------------------|
| <b>SPARE PARTS AVAILABLE:</b> | <b>4260-50RF</b> | <b>F72-4260/50RF</b> | Clear cup F72           |
| <b>AVAILABLE ACCESSORIES:</b> | <b>4461-50</b>   | <b>S63-4461-50</b>   | Fixing bracket Series73 |

### PRESSURE REGULATORS R72G - R74G MODELS, V72 QUICK EXHAUST VALVE

G1/4 to G1/2

Fluid: Compressed air

Inlet pressure: 20 bar max

Gauge port: G1/8 Female

Amb. Temperature: +2°C ...65°C (R72G), +80°C (R73-R74)

On request for use below + 2 ° C

Setting range: 0.3...10 bar

Standard relieving

Lockable knob



| Model      | Diameter | Flow dm <sup>3</sup> /s | Code              | A   | B  | C  | F  | G  | H  | D. Panel (thickness) |
|------------|----------|-------------------------|-------------------|-----|----|----|----|----|----|----------------------|
| <b>R72</b> | 3/8"     | 33                      | <b>R72G3GKRMN</b> | 73  | 33 | 26 | 50 | 48 | 35 | 40 (sp.0...4)        |
| <b>V72</b> | 1/4"     | 33                      | <b>V72G2GKNFN</b> |     |    |    |    |    |    |                      |
| <b>R74</b> | 1/2"     | 105                     | <b>R74G4GKRMN</b> | 127 | 43 | 31 | 80 | 74 | 56 | 52 (sp.2...6)        |

### LUBRICATORS L72 - L73 - L74 MODELS

G1/2"

The flow sensor provides a ratio oil / air almost constant over a 360° complete visibility, thanks to the clear dome for easy oil

Fluids: Compressed air

Inlet pressure: 10 bar max

Start point dm<sup>3</sup>/s : L74=0.94

*minimum flow required for lubricator operation at 6,3 bar*

Bowl capacity (Liters): L74 0.20 l

Amb. temperature: +2°C...+50°C

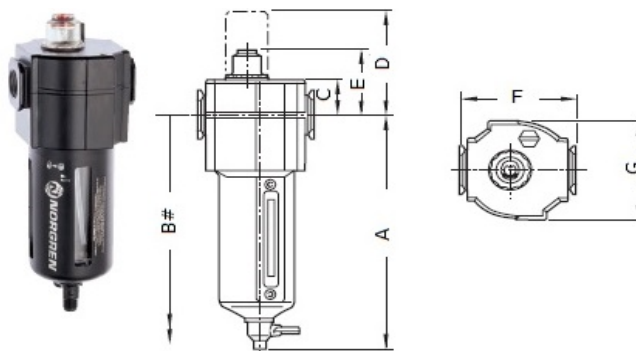

| Model                                 | Diameter | Flow dm <sup>3</sup> /s | Code              | A   | B   | C  | D  | E  | F  | G  |
|---------------------------------------|----------|-------------------------|-------------------|-----|-----|----|----|----|----|----|
| <b>L74 Protected transparent bowl</b> | 1/2"     | 70                      | <b>L74C4GPQPN</b> | 177 | 276 | 25 | 68 | 47 | 80 | 74 |



**SATEMA**

13856 VIGLIANO B.SE - Via Milano, 395

Tel. +39 015811102

Mail: [info@satema.it](mailto:info@satema.it) <http://www.satema.it>

## 18PFRL\* - COMPRESSED AIR TREATMENT

G3/8" compressed air filter, manual drain

Maximum pressure: transparent cup 10 bar

Operating temperature: -20°C\* to +50°C transparent cup

Filter element: Standard: 40 µm nominal

Max flow rate with pressure and inlet pressure 6.3 bar drop 0.5 bar: 28 dm<sup>3</sup>/s

BS 6005 compliant polycarbonate bowl as standard, zinc alloy body. Synthetic rubber elastomeric materials. Sintered plastic filter element

| Diameter | Code         |
|----------|--------------|
| G3/8"    | F11-300-M3TD |

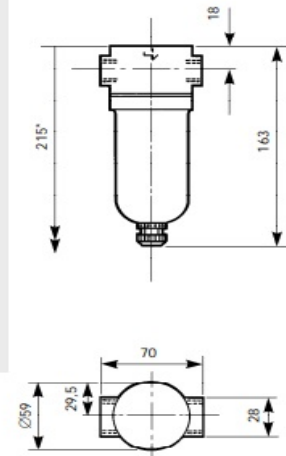

## AUTOMATIC DRAIN FILTER REGULATOR G 1"

Transparent bowl with metal protection

Pressure max: 16 bar

Regulation range: 0,8 ÷ 8 bar

Operating temperature: 0°C... +50°C

Filter element: 40 µm

Max condensate capacity: 105 cm<sup>3</sup>

Installation:

Modular, inline,  
wall and panel

Wall fixing screws: M6x90

Body: aluminium alloy

Filter Element: Sintered porous  
bronze

Spring: stainless steel

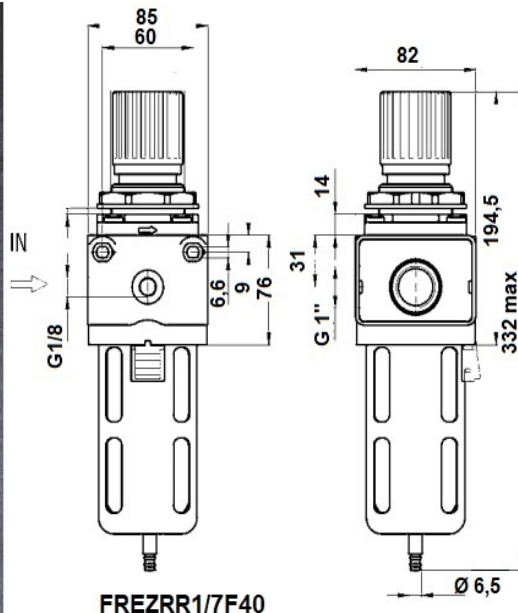

## REPLACEMENT FILTER ELEMENT EK600NA

Filter element used to remove solid particulate contamination from compressed air line providing the highest level of clean compressed air with no pressure loss. Manufactured to the highest quality standards including: ISO 9001, ISO 14001, Institute ADF 400-1999 Compressed Air and Gas, ISO/FDIS 8573-4 and sales code number 1DJ40 U.S. Government.



Diam. 48 x H 148 mm

**SATEMA**

13856 VIGLIANO B.SE - Via Milano, 395

Tel. +39 015811102

Mail: [info@satema.it](mailto:info@satema.it)

<http://www.satema.it>

## 18PFRL\* - COMPRESSED AIR TREATMENT

### MINIATURE REGULATORS R07

1/4"

Regulators threaded for generic pneumatic applications.

Fluid: only compressed air

Inlet Max pressure: 20 bar

Gauge port: Rc1/8

Ambient temperature: from 2°C to +65°C

Setting range: 0.3...7 bar std

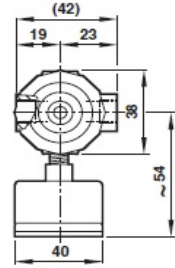
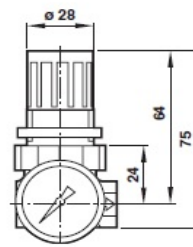

| Diameter  | Setting     | Flow dm3/s | Code           |
|-----------|-------------|------------|----------------|
| 1/4"      | 0.3...7 bar | 6.5        | R07200RNKG     |
| SPARE KIT | 3407-22     |            | R07-3407-22KIT |

### HIGH FLOW REGULATORS 20AG MODELS

G1/2" - G1"

Relieving standard. Non-relieving option. Standard relieving

Fluid: compressed air, neutral gas

Inlet Max pressure: 28 bar

Gauge port: G1/8 female

Ambient temperature: -20°C ... +80°C

Body/Bonnet: Zinc /Alluminum

Valve seat: brass

Regulation screw: stainless

Elastomers: Nitrile

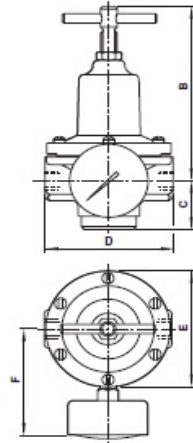

| Diameter  | Range bar | Relieving       | Adjustment, mounting | Mounting bracket | Code           |
|-----------|-----------|-----------------|----------------------|------------------|----------------|
| G1/2      | 0,1...3,5 | 20AGX4G/PD100 * |                      | 18-001-005       | 20AG-X4G/PD1   |
|           | 0,2...8   | 20AGX4G/PH100 * |                      |                  |                |
| G3/4-1"   |           |                 | T-bar, bracket       | 18-001-029       | R20AG-6/8STAFF |
| SPARE KIT | 481-01    | R20A-481-01     | MEMBRANE 20AG X 2/3  |                  |                |
|           | 482-01    | R20A-482-01     | MEMBRANE 20AG X 6/8  |                  |                |

### PRESSURE REGULATOR

G 1/2"

Extremely reliable and robust piston regulator

- Relief valve as standard
- Wall fixing through side holes in the body.

Flow: 2.500,00 l/min

Max Pressure: 18,00 bar

Temperature: -10...50 °C

Range: 0...8 bar



| GAUGE    |          | diam. 50                              |
|----------|----------|---------------------------------------|
| Type     | Range    | 07ACCM050AF012                        |
| standard | 0-12 bar | Back connection 1/8" and panel flange |

Other diameters and range on request

**SATEMA**

13856 VIGLIANO B.SE - Via Milano, 395

Tel. +39 015811102

Mail: [info@satema.it](mailto:info@satema.it) <http://www.satema.it>

## S68 SERIES - L15 MICRO-FOG LUBRICATOR

Micro-fog lubricator

Max Pressure: 16 bar

Cup capacity: 0,5 lt

Nax Flow: at 6.3 bar inlet pressure and pressure drop 0.5 bar = 178 dm<sup>3</sup>/s

Material: cup and body in aluminum alloy, seals in synthetic rubber



| LUBRICATOR          |              |
|---------------------|--------------|
| 18PFRL68-L15000MP90 | L15-000-MP90 |
| RING:               |              |
| 18PFRLS68-5520-89   | 5520-89      |

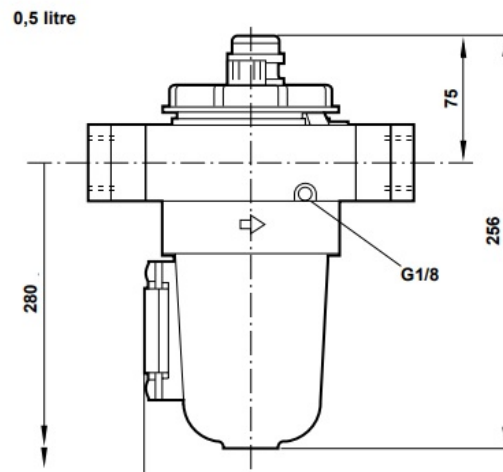
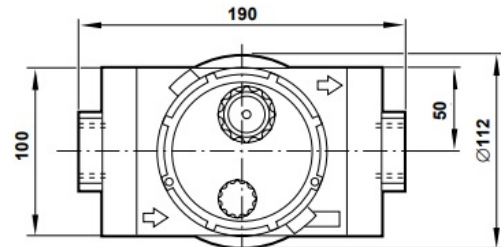

### OLYMPIAN 64 ACCESSORIES AND SPARE PARTS

|                      |                              |
|----------------------|------------------------------|
| 4348-89              | S64 PANEL MOUNTING RING      |
| 74503-51             | YOKE INTERCONNECTION         |
| 74504-50             | 64 SERIES BRACKET KIT        |
| Y64A-4GA-N1N         | SINGLE YOKE 1/2" CONNECTION  |
| Y64A-4GA-N2N         | DOUBLE YOKE 1/2" CONNECTION  |
| R15-100R (R68G-KITR) | SPARE PARTS KIT R68 (EX R15) |

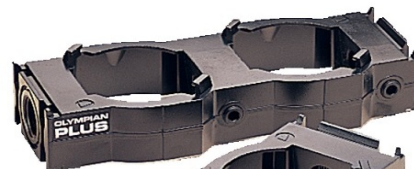

74503-51

74504-50



4348-89



**SATEMA**

13856 VIGLIANO B.SE - Via Milano, 395

Tel. +39 015811102

Mail: [info@satema.it](mailto:info@satema.it)

<http://www.satema.it>