

VSW - STAINLESS STEEL WAFER BALL VALVES

2-way flat body ball valv, full bore. Actuating lever or prepared with flange for actuator ISO 5211 - DIN 3337. Flanges: EN 1092-1: 2003. Upon request Antistatic system ATEX (Directive 94/9 / EC).



TECHNICAL SPECIFICATIONS

Material:	S.S. 304 or S.S. 316
Dimensions:	from DN15 to DN200
Seals:	standard virgin PTFE, on request PTFE glass or graphite filled, high density polyethylene
Working temperature:	-20...+160°C
Accessories:	ISO mounting kit

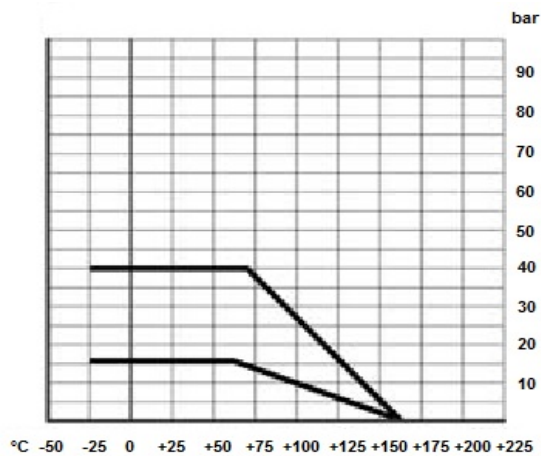

VERSIONS:

- with jacket
- ANSI 150 lever manual



SATEMA

13856 VIGLIANO B.SE - Via Milano, 395
Tel. +39 015811102 - 015510156 - Fax 0158853029
Mail: info@satema.it <http://www.satema.it>

MANUAL LEVER VERSION

Manual lever version

DN	15	20	25	32	40	50	65	80
PN	40	40	40	40	40	40	16	16
L	35	38	42	50	60	72	95	118
C	130	170	170	240	240	240	260	350
H	85	100	105	120	125	135	145	150
D	90	100	105	130	140	150	180	200
I	1,5	1,5	2	2	3	3	3	3
R	45	58	68	78	88	102	122	138
A	65	75	85	100	110	125	145	160
N°x M	4xM12	4xM12	4xM12	4xM16	4xM16	4xM16	4xM16	8xM16
Kg	1,46	2,08	2,38	4,53	5,94	7,95	14,97	21,92

DN	100	125	150	200	100	125	150	200
PN	16	16	16	16	16	16	16	16
L	152	185	235	310	140	185	235	310
C	508	370	584	584	508	370	584	584
H	165	181	249	288	165	181	249	288
D	220	255	295	373	220	250	285	340
I	3	3	3	3	3	3	3	3
R	158	188	212	268	158	188	212	268
A	180	210	240	295	180	210	240	295
N°x M	8xM16	8xM16	8xM20	12xM20	8xM16	8xM16	8xM20	12xM20
Kg	40	54,2	90,57	177,06	20	39,82	63,1	139

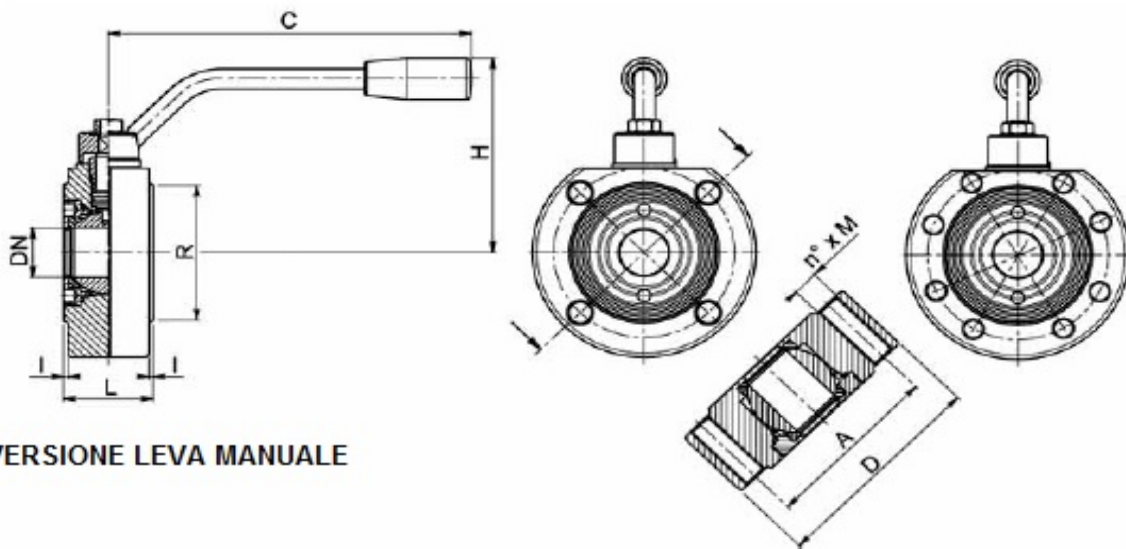

VERSIONE LEVA MANUALE



SATEMA

13856 VIGLIANO B.SE - Via Milano, 395

Tel. +39 015811102 - 015510156 - Fax 0158853029

Mail: info@satema.it <http://www.satema.it>

ISO 5211 VERSION

With flange for actuator ISO 5211

Maximum inrush opening in Nm

DN	15	20	25	32	40	50	65	80
PN	40	40	40	40	40	40	16	16
L	35	38	42	50	60	72	95	118
H	32,5	40	42,5	57,5	62	70	80,5	92
D	90	100	105	130	140	154	180	199
l	1,5	1	2	2	3	3	3	3
R	45	58	68	78	88	102	122	138
A	65	75	85	100	125	145	160	180
N°x M	4xM12	4xM12	4xM12	4xM16	4xM16	4xM16	4xM16	8xM16
Kg	1.36	1.95	2.26	4.22	5.66	8.3	14.6	21.47
ISO-DIN	F03	F04	F04	F05	F05	F05	F07	F07
d	10	11	11	16	16	16	18	18
o	-	-	-	-	-	-	-	-
quadro	6/9	9/11	9/11	14	14	14	17	17
E	36	42	42	50	50	50	70	70
F	M5	M5	M5	M6	M6	M6	M8	M8
Nm	8	12	15	18	25	30	45	85
DN	100	125	150	200	100	125	150	200
PN	16	16	16	16	16	16	16	16
L	152	185	235	310	140	185	235	310
H	101	119	164.5	204	191	119	164.5	204
D	220	255	295	373	220	250	285	340
l	3	3	3	3	3	3	3	3
R	158	188	212	268	158	188	212	268
A	180	210	240	295	180	210	240	295
N°x M	8xM16	8xM16	8xM20	12xM20	8xM16	8xM16	8xM20	12xM20
Kg	39	54,2	90,57	177,06	20	39,82	63,1	139
ISO-DIN	F10	F10	F12	F12	F10	F10	F12	F12
d	13.5	13.5	19.5	15	13.5	13.5	19.5	15
o	34	34	16	16	34	34	16	16
quadro	16xM27	16xM27	26xM42	26xM42	16xM27	16xM27	26xM42	26xM42
E	102	102	125	125	102	102	125	125
F	M10	M10	M12	M12	M10	M10	M12	M12
Nm	150	240	310	600	150	240	310	600

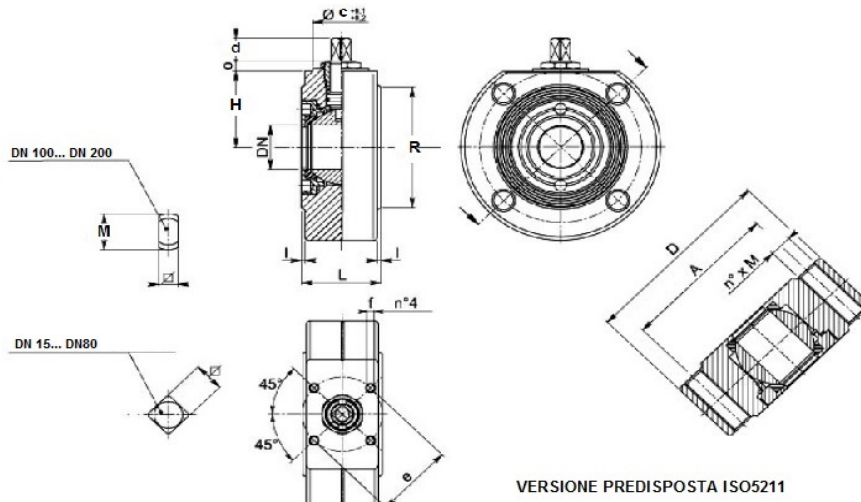

SATEMA

13856 VIGLIANO B.SE - Via Milano, 395

Tel. +39 015811102 - 015510156 - Fax 0158853029

Mail: info@satema.it <http://www.satema.it>

MATERIALS

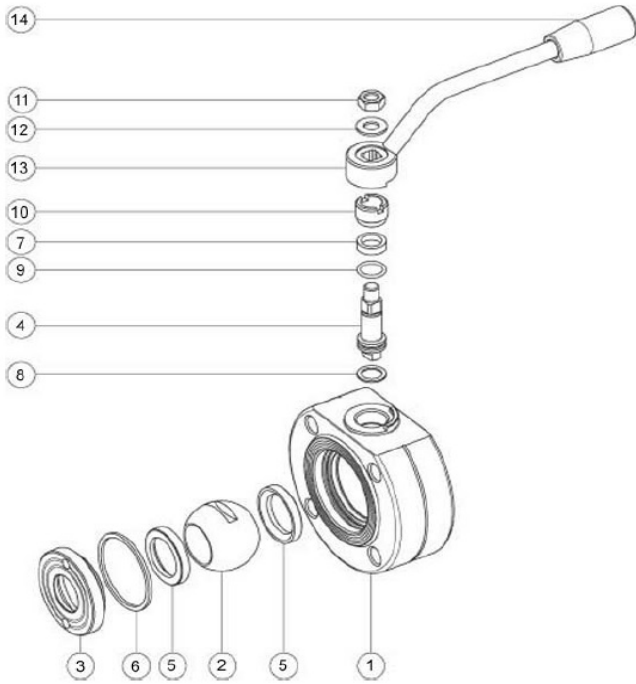

VERSIONE A LEVA MANUALE

MANUAL LEVER VERSION

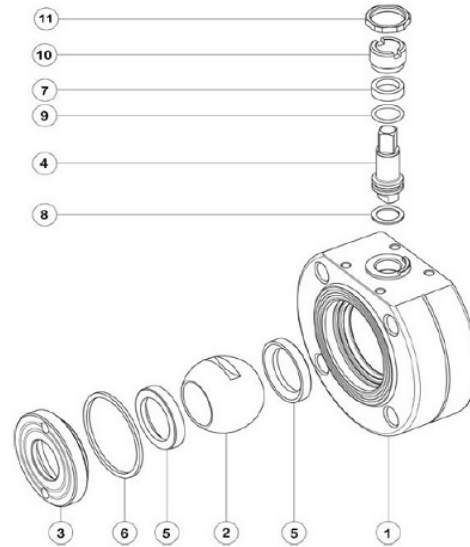

VERSIONE PREDISPOSTA FLANGIA ISO

ISO VERSIONE

MATERIALS

1 Body	SS304L or SS316L	8 Spindle seal	PTFE
2 Ball	SS304L or SS316L	9 Oring spindle sealing	FKM
3 Ring	SS304L or SS316L	10 Adjusting ring	S.S.304L (303)
4 Spindle	SS304L or SS316L	11 Nut	S.S.303
5 Ball seal	PTFE	12 washer	S.S.304L
6 Ring seal	PTFE	13 Lever	S.S.304L
7 Spindle seal	PTFE	14 Handle	Resin



SATEMA

13856 VIGLIANO B.SE - Via Milano, 395

Tel. +39 015811102 - 015510156 - Fax 0158853029

Mail: info@satema.it <http://www.satema.it>

VSW* BRASS-CAST IRON-CARBON STEEL WAFER BALL VALVES

Ball valves, full bore, PN16 Wafer. Possibility of mounting padlocking kit
Comply with Directive 97/23 / EC (PED)

Applications in function of the constructive materials:

- Water systems, heating / air conditioning, compressed air
- Aggressive media



VSWOT*



VSWG* Cast iron body



VSWAC1 Carbon steel ASTM A105

Mod.	VSWOT1	VSWOT2	VSWOT3	WSGH1	VSWG2	VSWG3	VSWAC1
Body	Brass			G25 Cast iron			Carbon steel A105
Ball	Brass	SS316	SS316	Brass	SS316	SS316	SS304
Shaft	Brass	Brass	SS304	Brass	Brass	SS304	SS420
Pressure	0...16 bar						0...40 bar (DN15...80) 0...25 bar (DN100...150)
Temperature	-10...+100°C						-20...+150°C

Brass and cast iron G25 - dimensions

DN	A	B	C	D	Weight kg.	Nm DP=16bar
20	40	130	105	4xM12	0.82	15
25	50	170	115	4xM12	1.25	18
32	55	170	140	4xM16	1.86	18
40	65	220	150	4xM16	2.42	18
50	80	220	165	4xM16	3.1	20
65	100	284	185	4xM16	5.23	40
80	120	384	200	8xM16	8.5	70
100	130	360	220	8xM16	12.4	70

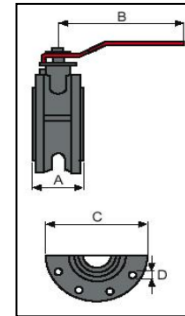

A 105 Carbon steel body - Dimensions

DN	A	B	H	D	Weight kg.	Nm DP=16bar
15	35	150	78	4xM12	1.5	3
20	42	185	87	4xM12	2	6
25	46	185	91	4xM12	2.7	13
32	55	280	106	4xM16	3.8	25
40	66	280	111	4xM16	6.5	30
50	72	280	120	4xM16	8	30
65	98	380	157	4xM16	15	60
80	120	380	161	8xM16	20	80
100	140	480	181	8xM16	30	120
125	177	480	205	8xM16	47	200
150	210	480	220	8xM20	49	250

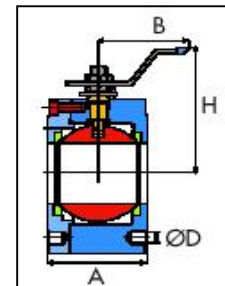

SATEMA

13856 VIGLIANO B.SE - Via Milano, 395
Tel. +39 015811102 - 015510156 - Fax 0158853029
Mail: info@satema.it <http://www.satema.it>