

18VFIN * - FINECORSA MECCANICI E MANUALI

VALVOLE IN LINEA G1/8", G1/4" Funzioni 3/2 - 5/2

Serie di valvole meccaniche e manuali con una ampia gamma di operatori. Adatte a flussi multidirezionali e per applicazioni a doppia pressione di alimentazione, forniscono elevate portate. Materiali leggeri e resistenti alla corrosione.

Fluido: Aria compressa filtrata, lubrificata e non lubrificata
 Pressione d'esercizio: Max 10 bar
 Temperatura ambiente: 0...+70°C



VALVOLE MECCANICHE

Azionamento / Riposizionamento	Funzione	Attacchi	Portata	Codice	Disegno
Leva rotella / molla	2/2	M5		18VFIN060117	-
	2/2	1/8"		18VFINVE13UW8-5	-
Leva rotella / molla Impiego pesante	3/2	1/8"	335	18VFIN03029302	A.10
	5/2	1/8"	335	18VFINX3039302	E.10
Leva rotella / molla	3/2	1/8"	335	18VFIN03041102	A.4
	3/2	1/4"	965	18VFIN03061102	B.9
	5/2	1/8"	335	18VFINX3045102	E.4
	5/2	1/4"	965	18VFINX3065102	F.9
Rotella / molla	3/2	1/8"	335	18VFIN03040202	A.2
	3/2	1/4"	965	18VFIN03060202	B.6
	5/2	1/8"	335	18VFINX3044202	E.2
	5/2	1/4"	965	18VFINX3064202	F.6
Pulsante / molla	3/2	1/8"	335	18VFIN03040002	A.1
	3/2	1/4"	965	18VFIN03060002	B.3
Leva rotella sensibile / molla	3/2	1/8"	335	18VFIN03042302	A.5
	5/2	1/8"	335	18VFINX3046302	E.5
Baffo / molla	3/2	1/8"	335	18VFIN03043202	A.8
	5/2	1/8"	335	18VFINX3047202	E.8

VALVOLE MANUALI

Azionamento / Riposizionamento	Funzione	Attacchi	Portata	Codice	Disegno
Leva / Leva	3/2	1/8"	335	18VFIN03029602	-
	5/2	1/8"	335	18VFINX3029602	-
Interruttore levetta / Interruttore levetta	3/2	1/8"	335	18VFIN03040302	A.22
	5/2	1/8"	335	18VFINX3044302	E.24
Leva / Leva	3/2	1/8"	335	18VFIN03043702	A.23
	3/2	1/4"	965	18VFIN03063702	B.31
	5/2	1/8"	335	18VFINX3047702	E.23
	5/2	1/4"	965	18VFINX3067702	F.31
Manopola rotante / Manopola rotante	3/2	1/8"	335	18VFIN03029802	A.26
	5/2	1/8"	335	18VFINX3029802	E.27
Pulsante / molla Colori Nero, Verde, Rosso	3/2	1/8"	335	18VFIN03040*02	A.12
Stop emergenza/rotazione manuale				* 4=Nero, 5=Verde, 6=Rosso	
	3/2	1/8"	335	18VFIN03029902	A.16
Push pull / Push pull	5/2	1/8"	335	18VFINX3029902	E.16
	3/2	1/8"	335	18VFIN03042502	A.21
Pedale / molla	5/2	1/8"	335	18VFINX3046502	E.26
	3/2	1/8"	335	18VFIN03048102	29
	3/2	1/4"	965	18VFIN03068102	29
	5/2	1/8"	335	18VFINX3048202	29
	5/2	1/4"	965	18VFINX3068402	29



SATEMA

13856 VIGLIANO B.SE - Via Milano, 395

Tel. +39 015811102 - Fax 0158853029

Mail: info@satema.it <http://www.satema.it>

G1/8, 3/2 richiamo a molla, corpo base

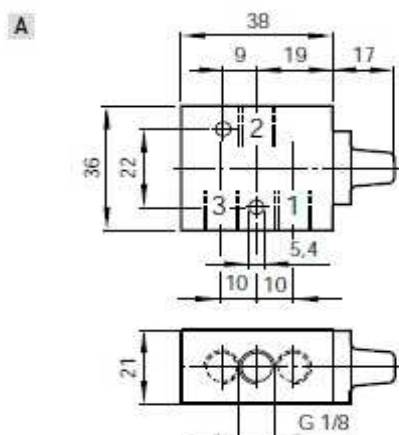

G1/4, 3/2 richiamo a molla, corpo base

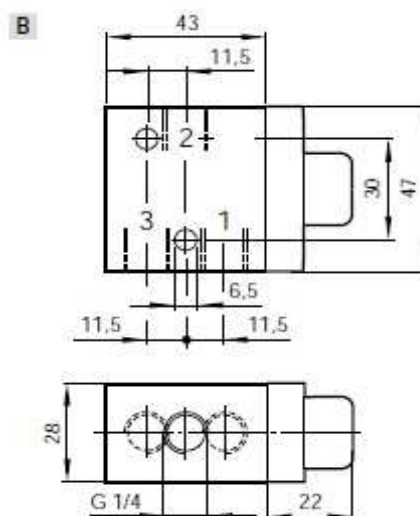

G1/8, 5/2 richiamo a molla, corpo base

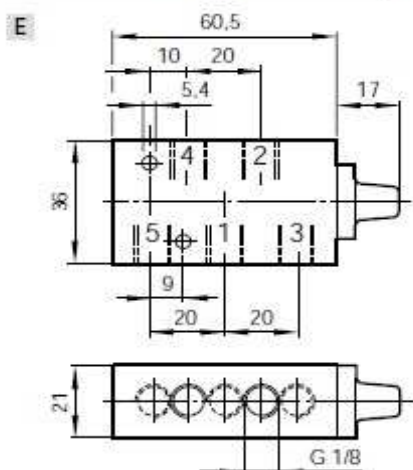

G1/4, 5/2 richiamo a molla, corpo base

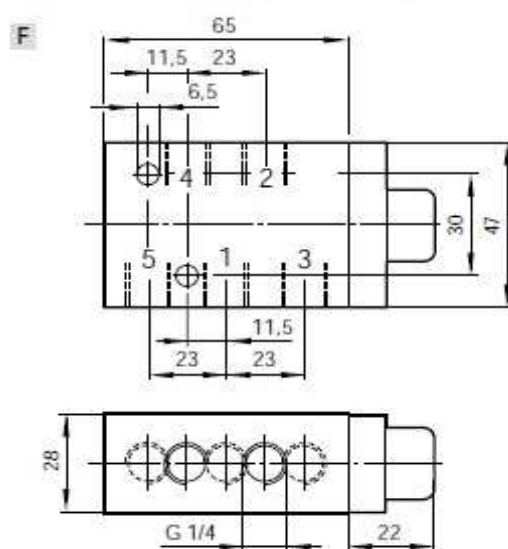

SATEMA

13856 VIGLIANO B.SE - Via Milano, 395

Tel. +39 015811102 - Fax 0158853029

Mail: info@satema.it <http://www.satema.it>

Pulsante - valvole G1/8

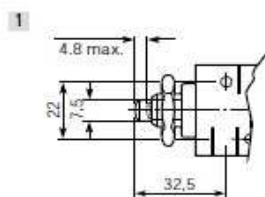

Rullo - valvole G1/8

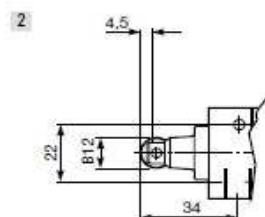

Pulsante - valvole G1/4

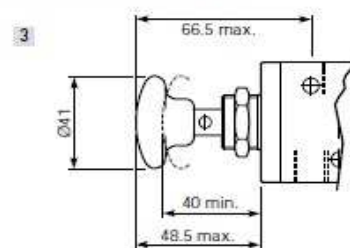

Leva a rulli - valvole G1/8

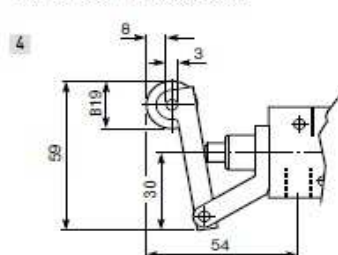

Leva a rulli sensibile - valvole G1/8

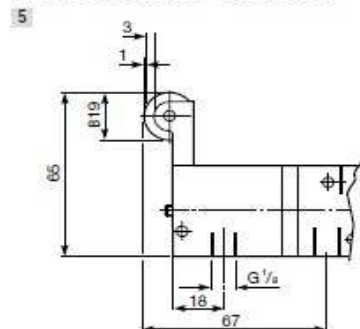

Rullo - valvole G1/4

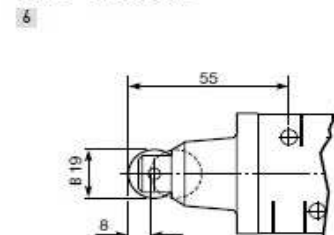

Antenna - valvole G1/8

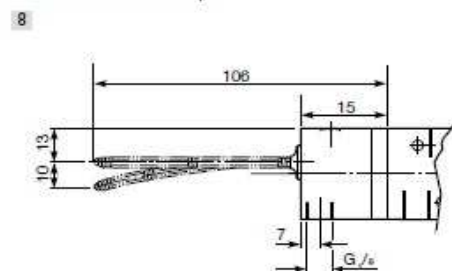

Leva a rulli - valvole G1/4

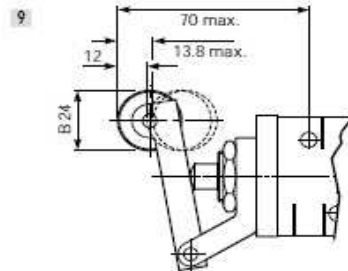

Leva a rulli per lavoro pesante - valvole G1/8

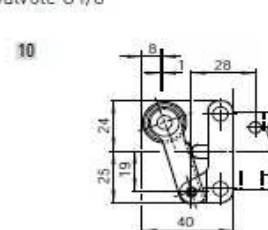

SATEMA

13856 VIGLIANO B.SE - Via Milano, 395

Tel. +39 015811102 - Fax 0158853029

Mail: info@satema.it <http://www.satema.it>

Pulsante - valvole G1/8

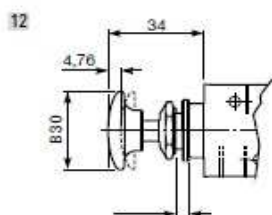

Arresto di emergenza - valvole G1/8

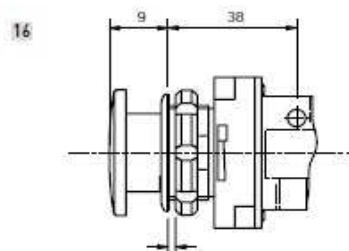

Manopola - valvole G1/8

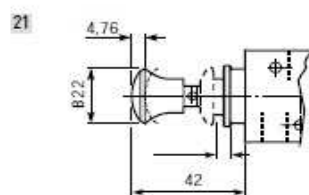

Valvola con molla di richiamo a leva - valvole G1/8

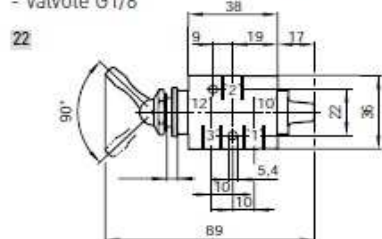

Valvola con molla di richiamo a leva - valvole G1/8

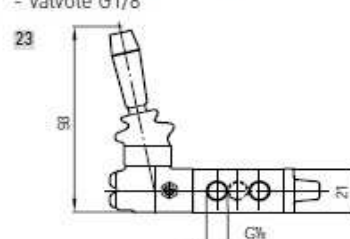

Interruttore - valvole G1/8

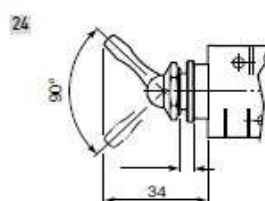

Valvola con manopola di richiamo - valvole G1/8

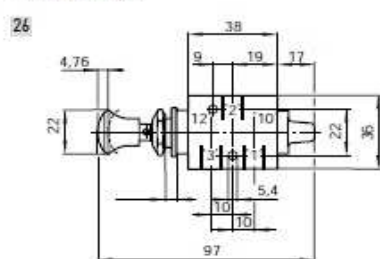

Pedale - valvole G1/8-G1/4

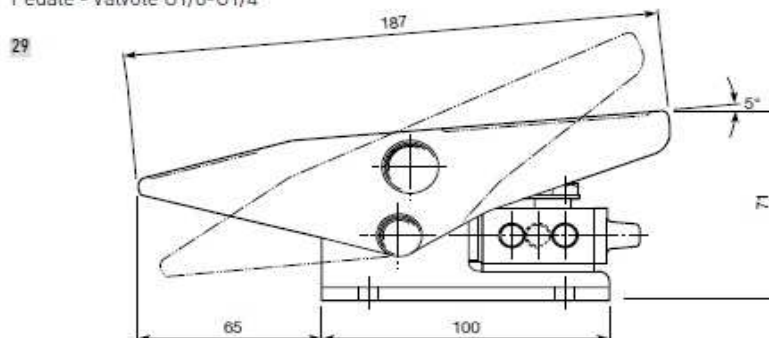

Manopola girevole - valvole G1/8

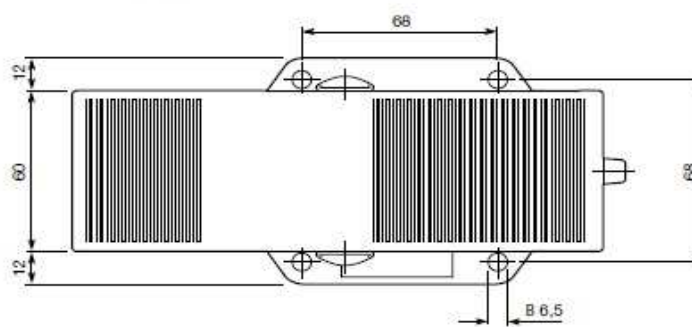
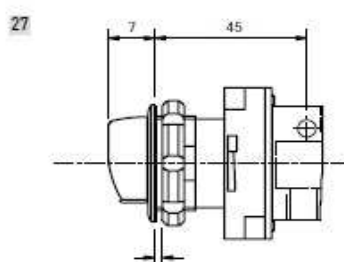

SATEMA

13856 VIGLIANO B.SE - Via Milano, 395

Tel. +39 015811102 - Fax 0158853029

Mail: info@satema.it <http://www.satema.it>

18VFIN * - FINECORSA MINIATURA

Finecorsa miniatura diametro interno 1,5 mm

Connessioni per tubo 4 mm

Portata 60 NI/min

Corpo lega di zinco

Otturatore poliuretano

Pressione 3-8 bar

18VFIN **PXC-M111**

Accessori:

18VFIN **PXC-Z11** Leva rotella plastica

18VFIN **PXC-Z12** Leva rotella plastica,
azionam. unidirezionale



PXC-M111

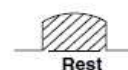
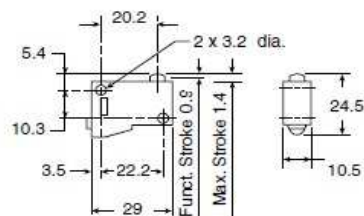

Rest

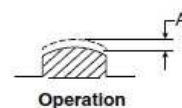

Operation



Maximum Travel



PXC-Z11 / Z12



SATEMA

13856 VIGLIANO B.SE - Via Milano, 395

Tel. +39 015811102 - Fax 0158853029

Mail: info@satema.it <http://www.satema.it>