

VSHTB HTB BALL VALVE UP TO 550°C

Ball valves for continuous service at temperatures up to 550 ° C

3-pieces "Split Body" construction, A105 carbon steel or 316 stainless steel body and ends, ball and stem.

Metal / graphite sealing seats

On request: flange ISO 5211 for actuator

Reduced or full bore versions:

- NPT ANSI B1.20.1; SW, BW thread
- UNI, DIN PN40, 64, 100 flanged
- ASME B16.34 class 300 and 600 flanged



FULL BORE Dimensions mm

DN	B	C	A thread NPT, SW, BW	UNI PN40 flanged		UNI PN63 flanged		UNI PN100 flanged		ASME300 flanged		ASME600 flanged		ISO 5211
				A	D	A	D	A	D	A	D	A	D	
1/2 - 15	110	180	90	130	95	210	105	210	105	140	95	165	95	F03
3/4 - 20	140	210	100	150	105	230	130	230	130	152	117	191	117	F03
1" - 25	164	270	110	160	115	230	140	230	140	165	124	216	124	F04
1"1/4 - 30	215	350	140	180	140	260	155	260	155	178	133	229	133	F05
1"1/2 - 40	220	350	150	200	150	260	170	260	170	191	155	241	155	F05
2" - 50	230	350	170	230	165	300	180	300	195	216	165	292	165	F05
2"1/2 - 65	235	500	210	290	185	340	205	340	220	241	190	330	190	F07
3" - 80	250	500	305	310	200	380	215	380	230	283	209	356	209	F07

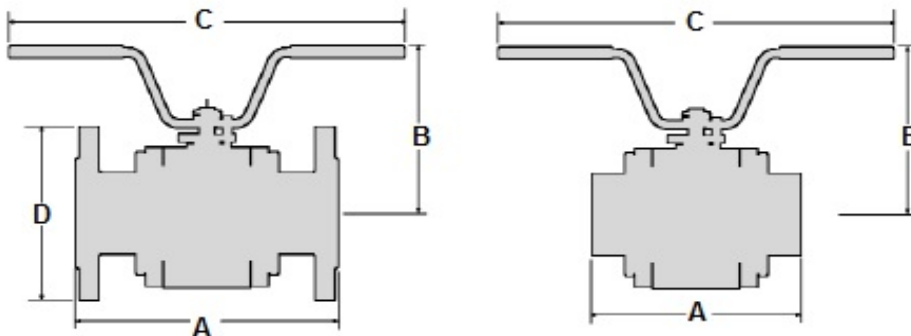

SATEMA

13856 VIGLIANO B.SE - Via Milano, 395

Tel. +39 015811102 - 015510156 - Fax 0158853029

Mail: info@satema.it <http://www.satema.it>

VSHTB BALL VALVE

Parts

- 1 Body
- 2 Inlet
- 3 Outlet
- 4 Screw
- 5 ball
- 6 Seat
- 7 Support ring
- 8 Gasket
- 9 Stem
- 10 Anti-friction ring
- 11 Packing
- 13 Stuffing box flange
- 14 Handle
- 15 Handle nut
- 16 Stuffing box tie rod
- 20 Plate
- 35 Autoseal gaskets > DN32
- 36 Spacer ring > DN20
- 37 Rod guide ring > DN20

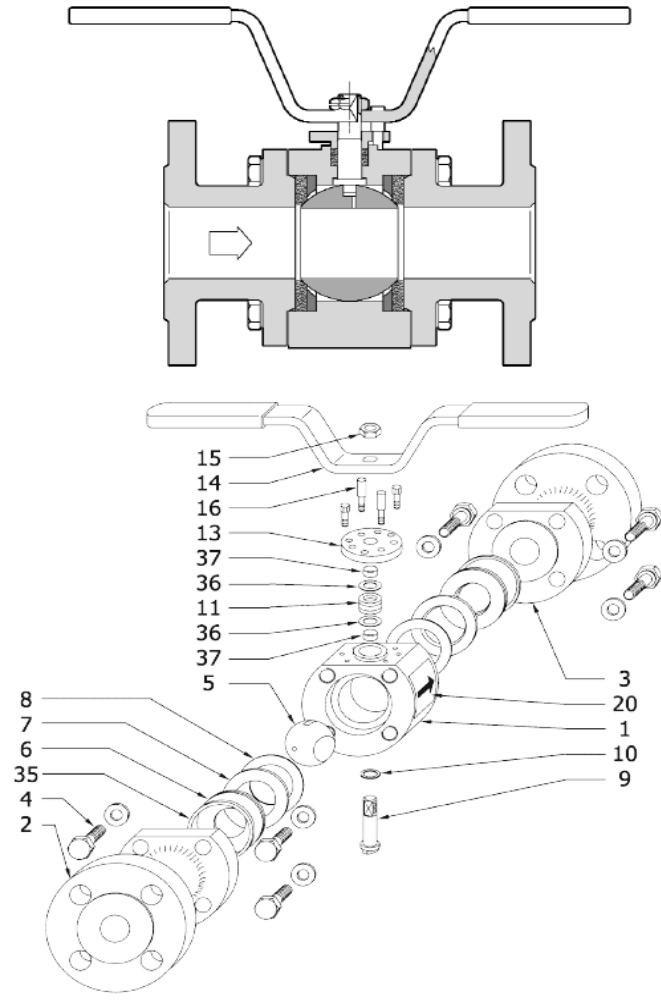

TEMPERATURE / PRESSURE RATING								
DIN VALVES				ASME VALVES				
Max working temperature °C	PN 40 bar	PN63 bar	PN100 bar	Max working temperature °C	300 class A105 bar	300 class SS 316 bar	600class A105 bar	600 class SS 316 bar
-10...20	40	63	100	-29...38	51.1	49.60	102.10	99.30
120	40	63	100	100	46.4	42.20	92.88	84.50
200	35	50	80	200	43.8	35.70	90.50	71.20
250	32	45	70	250	41.7	33.40	83.40	66.70
300	28	40	60	300	38.7	31.60	77.50	63.10
350	24	36	56	350	37.00	30.40	73.90	63.10
400	21	32	50	400	34.50	29.30	69.00	58.90
425	-	-	-	425	28.80	29.00	57.50	58.30
450	-	-	-	450	20.00	29.00	40.10	57.70
500	-	-	-	500	8.80	27.30	17.60	54.80
550	-	-	-	550	-	23.80	-	47.80



SATEMA

13856 VIGLIANO B.SE - Via Milano, 395
 Tel. +39 015811102 - 015510156 - Fax 0158853029
 Mail: info@satema.it <http://www.satema.it>